

RESIDENTIAL FENCES, HEDGES AND WALLS

- Building Permits are required for any fence that is a perimeter fence or a fence that is constructed to border the property.
- A fence must be completely installed on the owner's property. It shall be the responsibility of the property owner to know the location of property lines. If exact property lines are unknown, a professional survey may be necessary. The City of Devils Lake cannot be held responsible for improper fence placement.
- It is the property owner's responsibility to be aware of easements and not to construct a fence on such easements. Any fence constructed on an easement may need to be removed at the owner's expense.
- The maximum height of any residential fence shall be 6.5 feet. All fences shall be constructed of approved fencing materials.
- •Sight obscuring fences exceeding 36 inches in height will not be permitted to extend beyond established front yard setbacks. Fences in front yards are permitted to be 4 feet high if fences are 75% light permeable.
- Placement of sight obscuring fences, hedges or walls along intersections, alleys, and driveways is regulated to prevent sight restrictions, and promote safety for vehicles and pedestrians. In any case, fences, hedges, walls or obstructions shall not interfere with traffic.
- Sight obscuring fences, hedges, walls or obstructions greater than 24 inches in height, measured from the top of the nearest curb shall not be placed in the following locations:
 - Within the sight triangle formed from the corner of a right-of-way intersection in each direction for a distance of 20 feet. This distance shall be measured from the face of the curb.
 - Within the sight triangle formed from the corner of the intersection with an alley a distance of 10 feet in each direction. These distances shall be measured from the property lines.
 - Within the sight triangle formed from the corner of a driveway and a public right-of-way for a distance of 10 feet. These distances shall be measured from the driveway and property lines.
- Fences adjacent to public sidewalks must be held back a minimum of 2 feet from the sidewalk

State law requires you to call "North Dakota One Call" 1-800-795-0555 at least 48 hours before you dig.

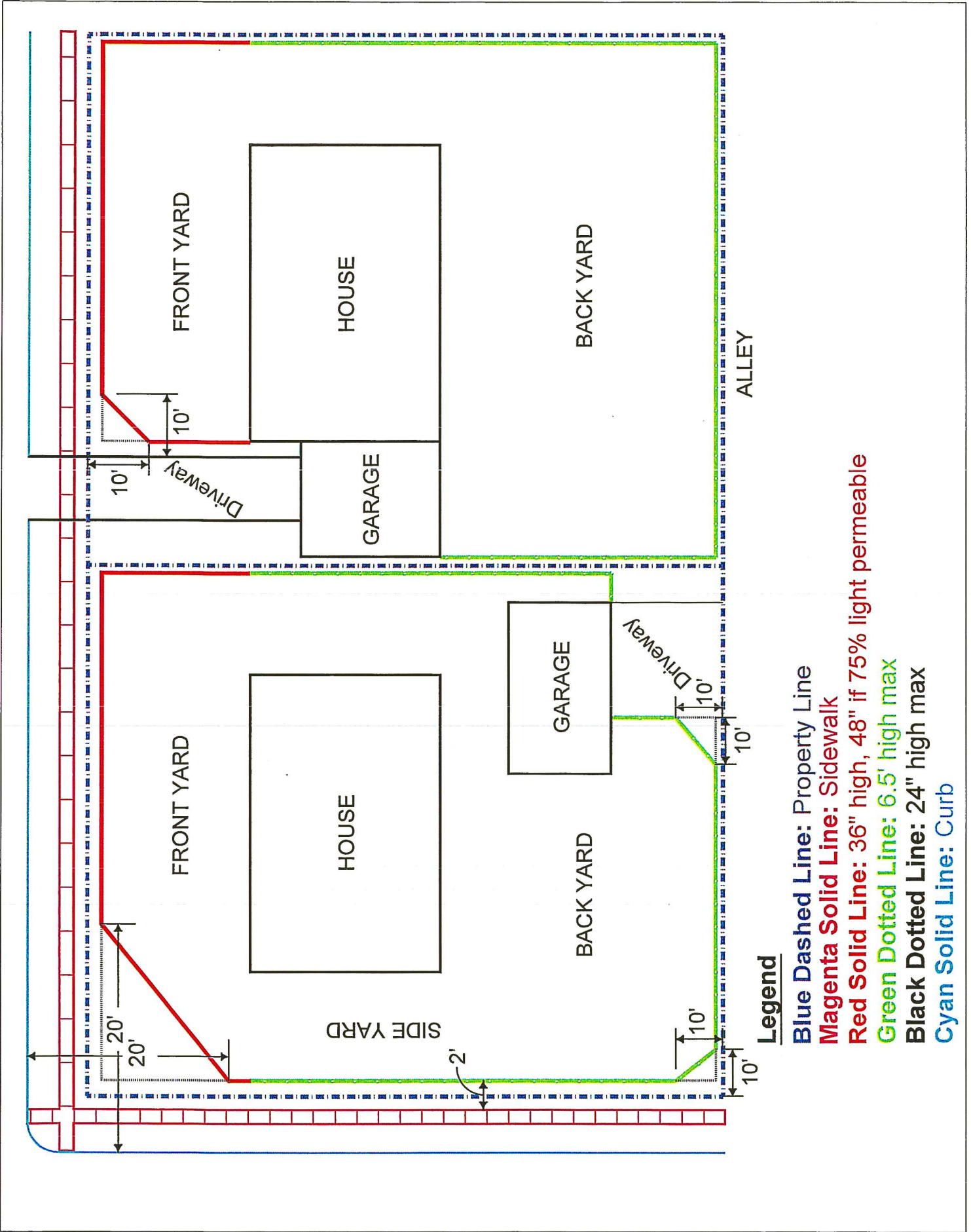

Legend

- Blue Dashed Line:** Property Line
- Magenta Solid Line:** Sidewalk
- Red Solid Line:** 36" high, 48" if 75% light permeable
- Green Dotted Line:** 6.5' high max
- Black Dotted Line:** 24" high max
- Cyan Solid Line:** Curb